

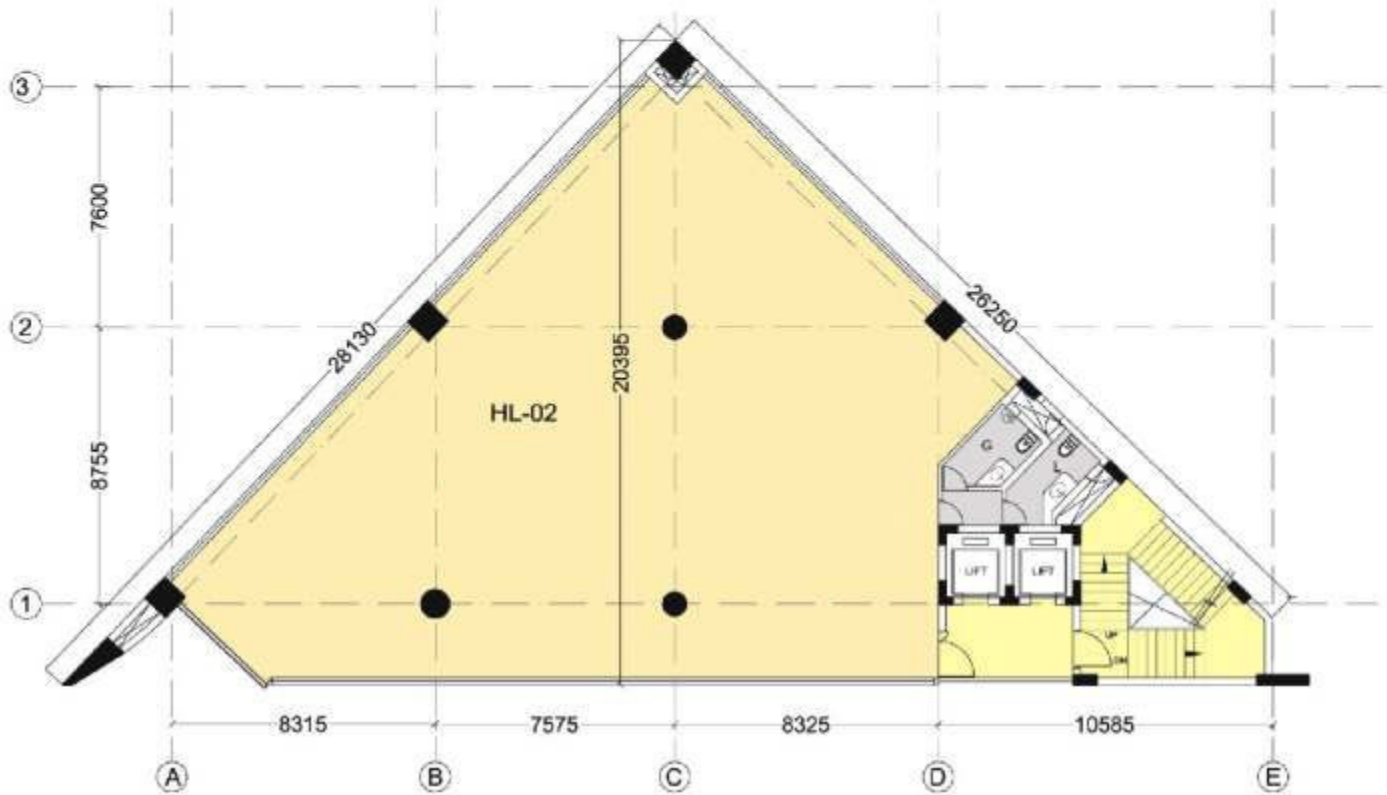

iris Tech Park - B Block

(Commercial & IT Office)



Typical Floor Plan : 5000 sq. ft. approx.

Total Area : $5000 \times 3 + 5000$ (LGF) + 5000 (Commercial) = 25000 sq. ft. approx.

Building Specifications

- Distinguished architectural design.
- Seismic Zone IV compliance (Earthquake resistant structure)
- **Ground Floor for Commercial (Food outlets & Restaurants) & 3 Floors for IT Office.**
- Suitable for food outlets and restaurant chains.
- External façade is suitably designed with a combination of heat reflective glass, stone and metal panels for greater energy efficiency.
- Common area finished with granite and marble stone.
- Plastered walls.
- Large column grid for greater work efficiency.

- Wet points at multiple locations for multiple drainage points.
- Hard & soft landscaping all round the building.
- Optimum open parking space.

Systems & Amenities

- 100 % Power back-up.
- Efficient fire protection system.
- Separate passenger and service lifts.
- Provision for centralised air-conditioning.
- Provision for air handling unit on each floor.
- Professional facility management services.

Trehan Promoters & Builders Pvt. Ltd.

Regd. Office : E-26, Panchshila Park, New Delhi - 110017
 Corporate Office : J/34 A, Central Market, Lajpat Nagar - II, New Delhi - 110024 Tel: 46546260/70 Fax: 46546280
 For any queries, please log onto www.trehanbuilders.com or e-mail: info@trehanbuilders.com