

THE WESTIN
RESIDENCES
GURUGRAM

An Oasis Of
Serene Elegance



Table of Content

Section 01

VISIONARIES

Section 05

THE LOCATION

Section 9

LAYOUTS

Section 02

WELCOME INTRODUCTION

Section 06

PROJECT OVERVIEW- MASTER PLAN

Section 10

PAYMENT PLAN

Section 03

6 PILLARS OF WELL-BEING

Section 07

LANDSCAPING

Section 04

CONCIERGE SERVICES & ONVIA

Section 08

THE RESIDENCE

Visionaries-
Whiteland &
Consultants on-board



Developed By

WHITELAND

Global Outlook | Indian Values

Revolutionizing Real Estate In India

- Redefining industry standards through innovative, international-standard projects.
- Focus on outstanding craftsmanship, sustainability, and customer satisfaction.
- Vision to “Build a Better Tomorrow” at the core of operations.
- A team of 200+ employees, 350+ channel partners, and over 25 leading consultants from India and abroad.
- Topline revenue target of ₹35,000 crores in next five years.
- 6 marquee projects with 12 m. sq. ft. under development.

Design Consultant

Architect
Hafeez
Contractor

AHC is renowned for bold designs, tailored solutions, and exceptional execution. Its rapid growth and elite portfolio reflect a commitment to excellence.

Interior Consultant

BM&A
BOBBY MUKHERJI & ASSOCIATES

BM&A crafts bespoke environments globally, tailoring designs through in-depth research. Their context-driven approach ensures customer-centric, culturally attuned spaces.

Landscaping Consultant

 COOPERS HILL

Coopers Hill, an award-winning consultancy, excels in landscaping, urban design, and master planning. Their diverse team crafts spaces that harmonize people with nature.

Lighting Consultant

asa
LIGHTING DESIGN STUDIOS

ASA, a global leader in lighting design, brings 20+ years of expertise across 200+ projects. Their award-winning team blends global vision with local insight.

THE WESTIN
RESIDENCES
GURUGRAM

Welcome Introduction

Brand Portfolio

EDITION[®]



THE RITZ-CARLTON

THE
LUXURY
COLLECTION



ST. REGIS

BVLGARI
HOTELS & RESORTS

W
HOTELS

RITZ-CARLTON RESERVE

WESTIN

M
MARRIOTT

JW MARRIOTT[®]

SHERATON
EST. 1937

Le MERIDIEN

AUTOGRAPH
COLLECTION[®]
HOTELS

R
RENAISSANCE[®]

TRIBUTE
PORTFOLIO



World's Largest Branded Residences Company

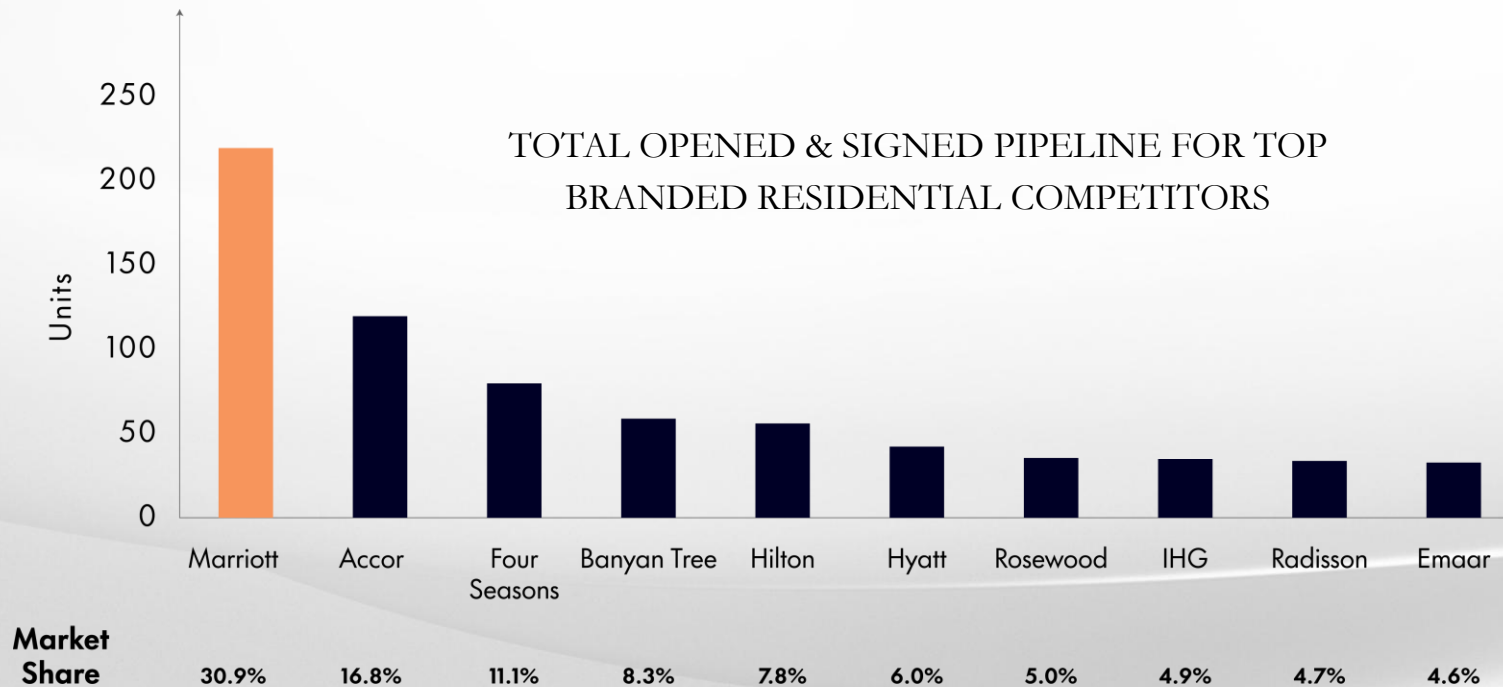

Global Distribution

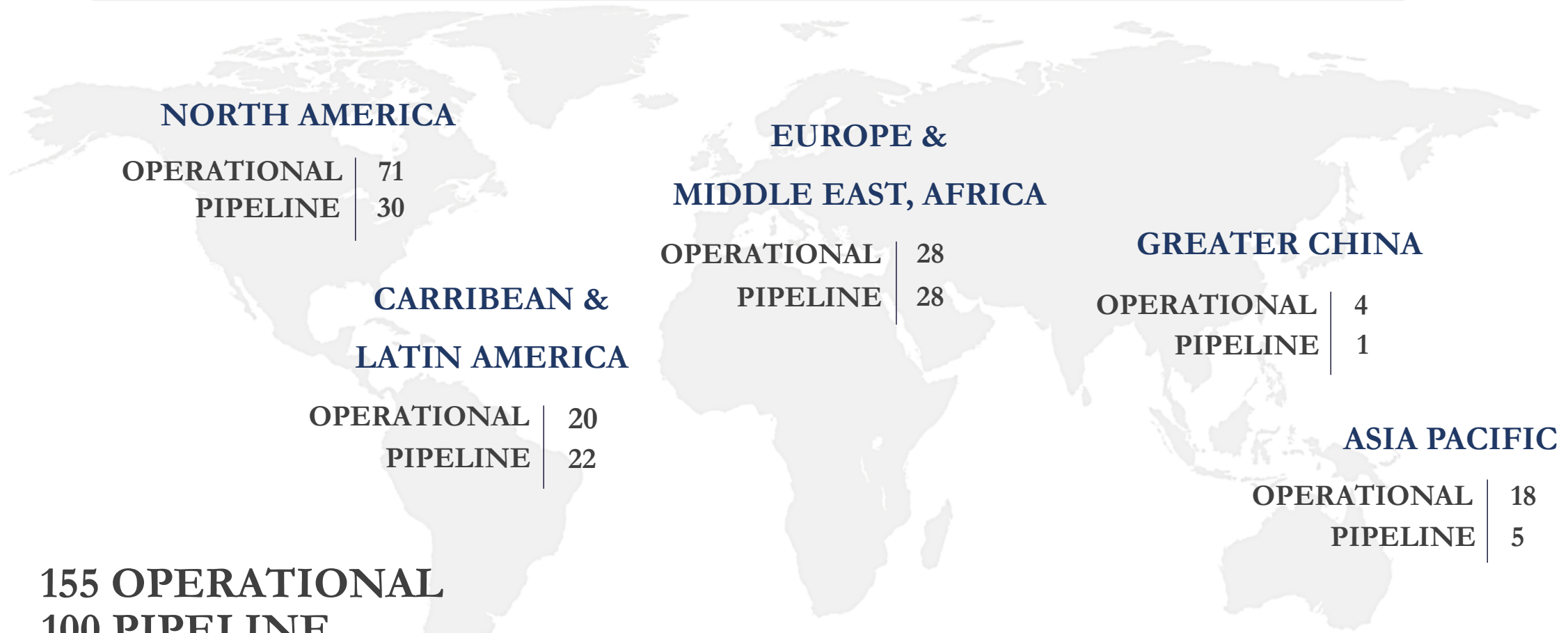

155 OPERATIONAL
100 PIPELINE

49 COUNTRIES & TERRITORIES

76% LUXURY & 24% PREMIUM

Greater Capital Appreciation

Non-Branded Residences

Project: Lux 6, Saigon, Vietnam

Price: 37k per Sq. Ft.

Project: Lodha World Towers, Worli, Mumbai

Price: 51k per Sq. Ft.

Branded Residences

Project: JW Marriott Residences, Saigon, Vietnam

Price: 1.8L per Sq. Ft.

Project: The Ritz Carlton, Worli, Mumbai

Price: 1.5L per Sq. Ft.

Greater Capital Appreciation

Non-Branded
Residences

X

V/S

Branded
Residences

2/3 X

THE WESTIN
RESIDENCES
GURUGRAM

Iconic
Developments
Across The Globe



The Westin Residences, Greece



Marriott
INTERNATIONAL

Westin Residences at Trillium House, Canada



The Westin Residences, England



Artistic Impression

The Westin Residences, Philippines

Whiteland Corporation and Marriott International sign an agreement to introduce Westin Residences to Gurugram, India

Whiteland Corporation, a real estate developer based in Delhi-NCR, announced and signed an agreement with **Marriott International, Inc.**, to bring **Westin Residences** to Gurugram, India.

Located along the growth corridor of Dwarka Expressway, Westin Residences Gurugram is strategically positioned in Sector 103, a 15-minute drive to the CBD of Gurugram, and 15-20 minute drive to residential areas of South and West Delhi, and close to International Airport and landmarks, such as India International Convention Centre (Yashobhoomi), upcoming DDA Dwarka Golf Course and Diplomatic Enclave — a premium catchment of expats and diplomats catering to over 35 embassies.

The Westin Residences Gurugram is slated to be the largest branded residences and the first stand-alone residential, without a hotel on-site, property in India under the renowned Westin brand. It promises to be a blend of exclusivity, wellness, and world-class hospitality. The Residences is poised to meet the growing demand in India from discerning buyers seeking hotel-inspired lifestyle with personalised services, global concierge and more. The first phase, consisting of 674 exclusive residences, is set to launch in the second quarter of this financial year.

The Residences will be an urban resort featuring three- and four-bedroom residences ranging from 235sqm to 386sqm, where homeowners will have access to high-end amenities while enjoying 20 acres of beautifully landscaped grounds dedicated mainly to recreation and



L-R: Pankaj Pal, MD, Whiteland Corporation; Navdeep Sardana, Founder, Whiteland Corporation; Penny Trinh, VP, Residential Development, Marriott International; and Anwesha Bhuyan, VP and Corporate Counsel, Marriott International were present at the event

PHOTO: HTCS

outdoor activities. Additionally, the Residences will be elevated on stilts, allowing the landscape to flow underneath them, maximising the site area dedicated to green spaces. Taking inspiration from the concept of a biophilic design, it has been curated by internationally acclaimed designers and consultants, including Design Consultant Architect Hafeez Contractor, Landscaping by Coopers Hill and Interiors by BM&A.

The Residences will embody the Westin brand's Six Pillars of Well-Being: Sleep Well, Eat Well, Move Well, Feel Well, Work Well and Play Well. From the WestinWORKOUT® offerings and nutritious culinary

options, residences will benefit from an array of distinct wellness experiences on-site, leveraging the brand's

ABOUT WHITELAND CORPORATION

Whiteland Corporation is a leading real estate developer in Delhi-NCR, India, known for its commitment to excellence, innovation and sustainability. With a global outlook combined with Indian values, the company has been crafting distinguished developments across residential and commercial sectors. Its portfolio includes prestigious developments covering approximately 4.5 million sqft of area under development,

reputation as an industry leader in well-being. The exclusive Clubhouse will be the crown jewel among the

comprising 1,300+ homes. World-class commercial spaces that have already been constructed are highly appreciated by the market. Whiteland prioritises timely project delivery without compromising quality. Driven by a culture of trust, honour and unwavering commitment, Whiteland Corporation is redefining industry standards and delivering extraordinary client experiences.

For more information, visit: www.wlcorp.com

WHITELAND

Global Outlook | Indian Values

- Westin Residences Gurugram will be the first residential development in India under the Westin brand.
- This development will also be the largest stand-alone branded residences project announced in India

bring pride and joy to its residents. Our commitment to creating world-class residential developments, supported by award-winning international consultants, ensures an unparalleled ecosystem for our buyers."

John Hearn, Senior Vice President, Global Residential Operations, Marriott International, said, "We are delighted to have signed an agreement with Whiteland to introduce the first Westin Residences to India. Their pioneering spirit and unwavering commitment to excellence, combined with Marriott's global experience in operating branded residences, will set a benchmark in premium living in India and create homes where residents can be the best versions of themselves."

HTC

Note: The Westin Residences Gurugram are not owned, developed, promoted or sold by Marriott International, Inc. or its affiliates ("Marriott").

Whiteland Corporation Private Limited uses the Westin trademarks and trade names under a license from Marriott, which has not confirmed the accuracy of any of the statements or representations made herein.

THE WESTIN RESIDENCES GURUGRAM

Agreement Signed on 4th July 2024
with Marriott International.

RESIDENCES
BY MARRIOTT INTERNATIONAL

HIDE FILTER

16 PROPERTIES

APPLIED FILTERS

Westin Residences

Hide sold out properties

LOCATIONS

British Columbia

California

Colorado

Egypt

Greece

India

Michigan

Minnesota

PORTUGAL



WESTIN RESIDENCES
THE RESIDENCES AT THE
WESTIN SALGADOS
BEACH RESORT ALGARVE ↗

INDIA



WESTIN RESIDENCES
WESTIN RESIDENCES
GURUGRAM ↗

EGYPT



WESTIN RESIDENCES
WESTIN RESIDENCES,
NEW CAPITAL, CAIRO

UNITED KINGDOM



WESTIN RESIDENCES
THE RESIDENCES AT THE
WESTIN LONDON CITY ↗



Map data ©2025 Terms

The image shows a modern residential complex with several tall, curved buildings featuring balconies and glass railings. In the foreground, there is a well-manicured garden with a swimming pool. The pool area is surrounded by dense greenery, including palm trees and various shrubs. A blue slide is visible on the left side of the pool. Several people are seen relaxing in the garden, some sitting at tables near the pool and others on lounge chairs. The overall atmosphere is serene and elegant.

An Oasis of Serene Elegance surrounded by Delhi Greens,
Westin Residences Gurugram offers an elevated lifestyle
with personalized services and world-class amenities.

With ample sunlight and generosity of space, this
ecosystem of abundance combines biophilic architecture
with a holistic focus on health and well-being, setting a new
benchmark for India and beyond.

India's Largest Branded Residences with World-Class Standards

- Pristine master-planned community offering ultimate connectivity.
- Haven of serenity redefining holistic living. Spacious 3 & 4 BHK Residences.
- Design prioritises sustainability and well-being.
- Biophilic architecture to enhance residents' connection to nature.
- The Clubhouse to feature personalized amenities centered around wellness, recreation, and dining.



A man and a woman are sitting in a swimming pool, looking at each other and smiling. The woman is wearing a dark blue one-piece swimsuit and is sitting on the edge of the pool. The man is shirtless and is sitting next to her. The background shows a lush green landscape with trees and a poolside area with lounge chairs and umbrellas.

Empowering Residence Owners to regain control and enhance their well-being, ensuring they can be the best version of themselves.

THE WESTIN
RESIDENCES
GURUGRAM

6 Pillars of Well-Being

The 6 Pillars of Well-Being

Stay well wherever life takes you with 'The Residences', designed for a perfect balance.

Thoughtful amenities empower well-being, helping you live, work and feel your best.



Sleep Well



Eat Well



Move Well



Feel Well



Work Well



Play Well

Westin creates immersive experiences to leave residents feeling better than
When they arrive through our 6 pillars of well-being.

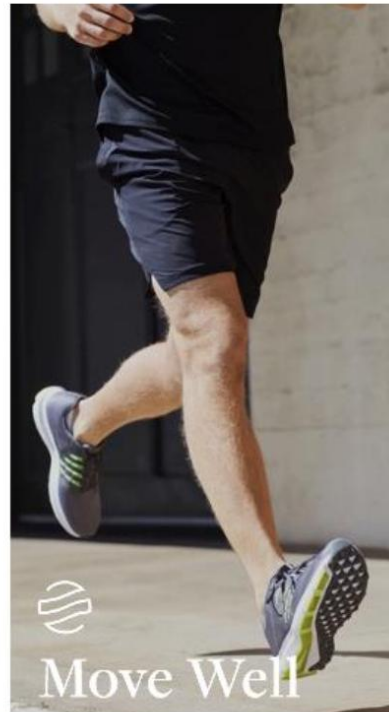

- Heavenly® Bed
- Sleep Well Lavender Balm Amenity
- Sleep Well Menu

- Westin Eat Well Menu
- Westin Eat Well Menu for Kids
- Westin Fresh by The Juicery

- WestinWORKOUT®
- Fitness Studio
 - Routes x Strava
 - Gear Lending
 - Run Concierges (optional)
 - Fitness Room (optional)

- Heavenly® Bath
- Sensory Welcome
- Heavenly Spa (optional)

- Westin Meetings

- Westin Family
- Westin Family Kids Club

THE WESTIN
RESIDENCES
GURUGRAM

Concierge Services & ONVIA



Hotel inspired Concierge Services

Westin Residences offer a perfect balance of serene living and world-class hospitality. With signature services and amenities residents enjoy personalized concierge, 24/7 security, and seamless hospitality.



Doorman Welcome



Meeting- Conference Rooms



Guest Suites



In Residence Dining



Housekeeping



Spa & Salon



Residence Owner Recognition Platform

VIP recognition and preferred access when staying at participating Marriott International hotels & resorts worldwide.

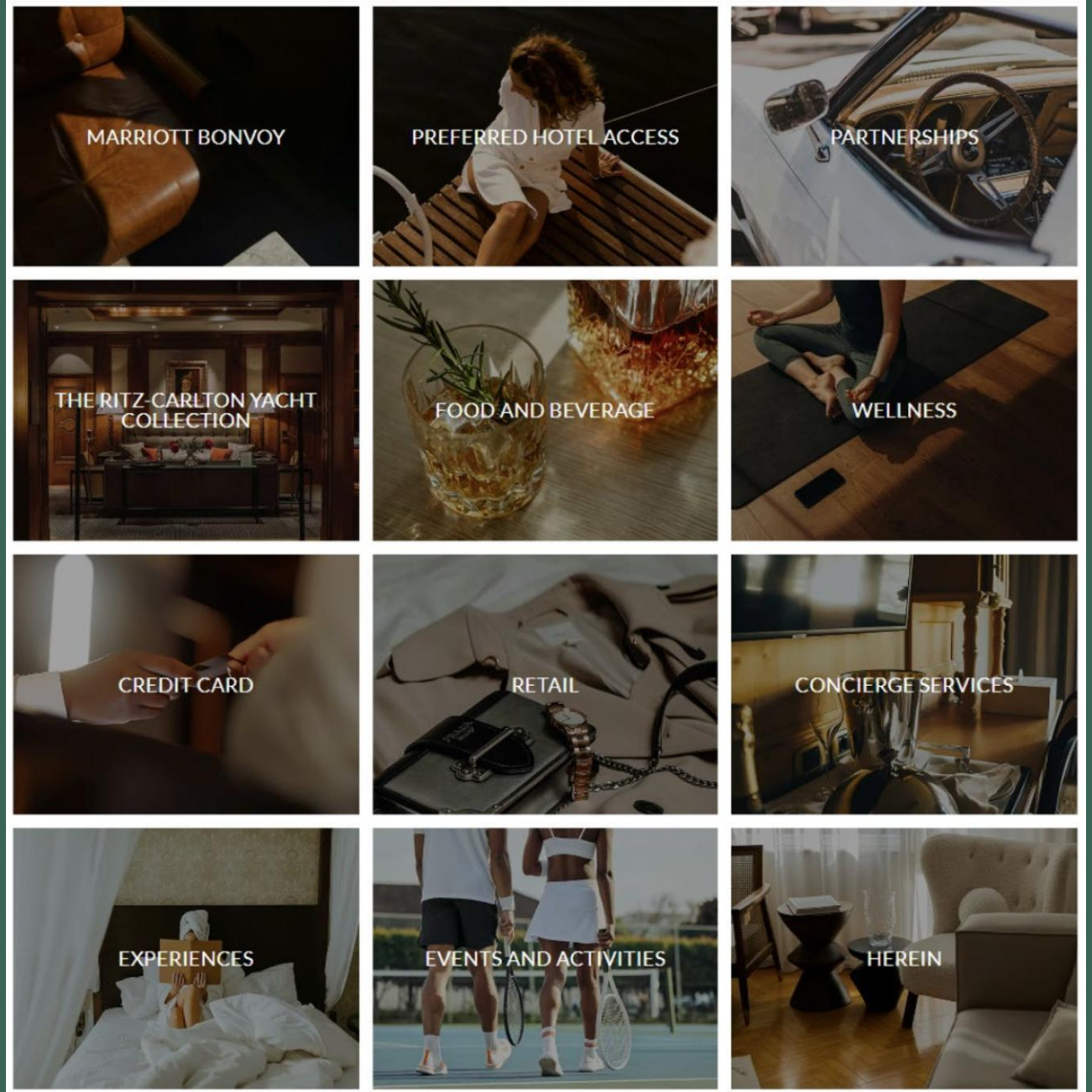

THE WESTIN
RESIDENCES
GURUGRAM

Location

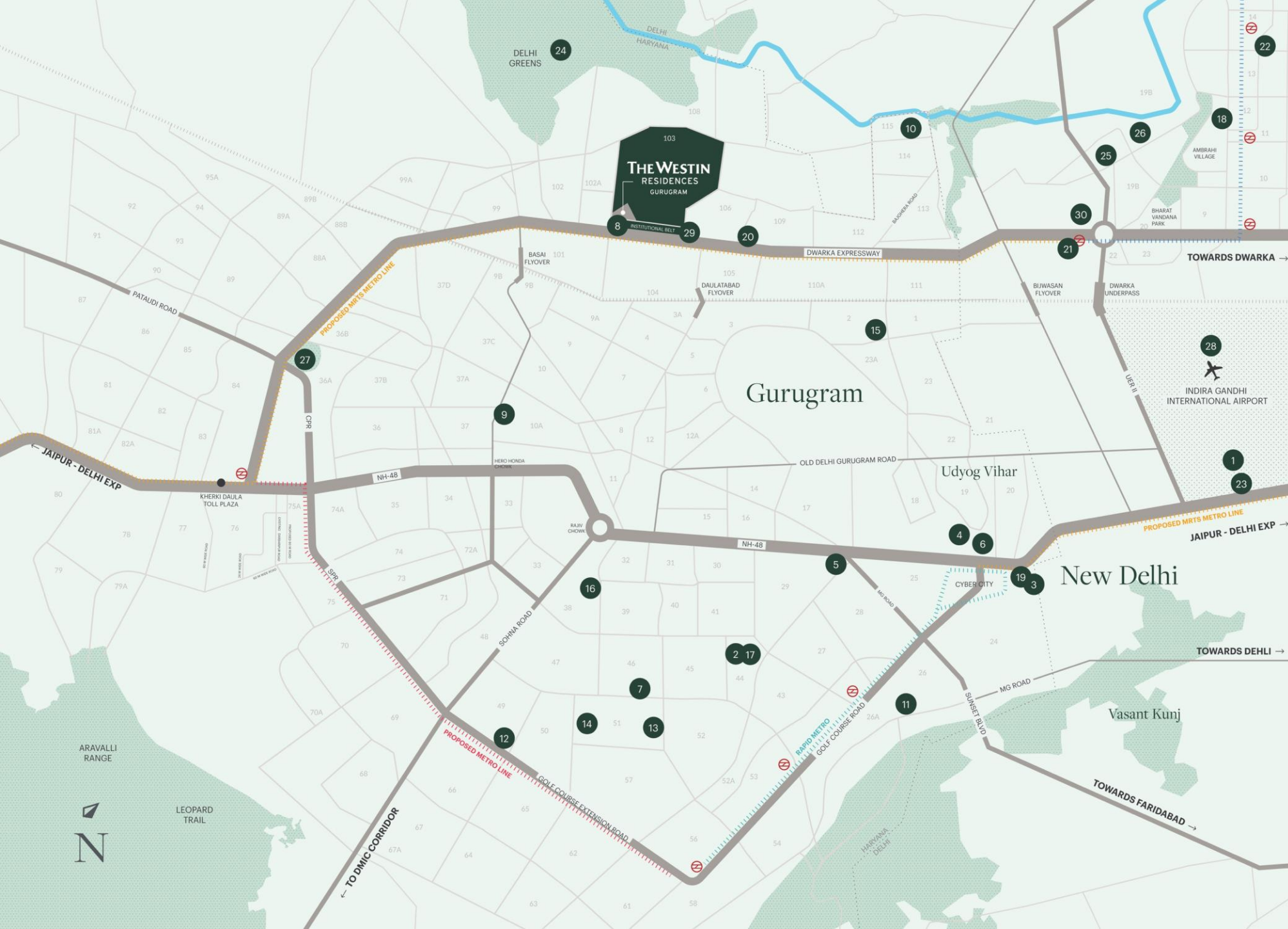

HOTELS

01. JW Marriott Hotel New Delhi Aerocity
02. Taj City Centre Gurugram
03. The Leela Ambience Gurugram
04. The Oberoi, Gurgaon
05. The Westin Gurgaon, New Delhi
06. Trident Hotel

SCHOOLS

07. Amity International School
08. Delhi Public School
09. GD Goenka Public School
10. Mount Carmel School
11. Shiv Nadar School
12. St. Xavier's High School

HOSPITALS

13. Artemis Hospital
14. CK Birla Hospital
15. Manipal Hospital
16. Medanta Hospital
17. Fortis Hospital
18. Venkateshwar Hospital

MALLS

19. Ambience Mall
20. Concient One
21. Pacific D 21 Mall
22. Vegas Mall

OTHERS

23. Aerocity
24. Delhi Greens
25. Diplomatic Enclave II
26. Dwarka Golf Course
27. Global City
28. Indira Gandhi International Airport
29. Institutional Belt (103)
30. Yashobhoomi Convention Centre

Enjoying a Socio Fabric of both- Delhi & Gurugram

- 5 Mins to **Global City**
- 7 Mins to **The Trumpet Flyover**
- 10 Mins to **Yashobhoomi (IICC)**
- 12 Mins to **Bharat Vandana Park**
- 13 Mins to **Dwarka Golf Course**
- 15 Mins to **Diplomatic Enclave II**
- 15 Mins to **Indira Gandhi International Airport**



Project Overview & Masterplan

Project Overview

- **Architectural Concept:** A vast, serene expanse development with 95% dedicated to greenery, offering a tranquil retreat.
- Land Parcel: **20 Acres** (approx.) (**10 Acres in Phase 1 & 10 Acres in Phase 2**)
- Westin Club: Spread across **1.75 L SQ. FT.** (approx.) of expanse
- Average Unit Size: **2,700 SQ.FT. to 4,500 SQ.FT.** (**250 to 418 SQ. M.**)



Masterplan Composition

- **Zero Ground-Level Vehicle Movement**
- **Grand Lobbies & Stilts:** Each tower boasts of impressive 30 ft. high stilts and ground-floor lobbies.
- **Exclusive Club Access:** Separate entry and exit points to the clubhouse, designed with sunken decks.
- **Perimeter Walking & Cycling Loop.**
- **Diverse Activity Tracks:** Specialised tracks for cycling, walking, and jogging, catering to varied fitness and leisure preferences.
- **Panoramic Tower Views:** Most towers offer spectacular views of the central landscaped areas, immersing residents in nature's beauty.



THE WESTIN
RESIDENCES
GURUGRAM

Landscaping

The image depicts a lush, modern garden oasis. In the foreground, there's a large, rectangular reflecting pool with a low wall and a waterfall effect. The pool is surrounded by dense greenery, including palm trees and flowering plants. A paved path leads through the garden. In the background, a tall, modern high-rise building with a glass facade and balconies stands against a clear blue sky. A semi-circular seating area with orange cushions and a white pergola is visible near the pool. The overall atmosphere is peaceful and serene.

Tranquil Green Oasis

- **Lush Greenery:** Expansive lawns, native trees, and vibrant garden beds.
- **Serene Water Bodies:** Reflecting pools, cascading waterfalls, and koi ponds.
- **Vehicle-Free Pathways:** Dedicated pedestrian walkways and bicycle lanes.
- **Cozy Sit-Outs:** Open-air cabanas, hammocks, and shaded seating areas.
- **Sustainable Features:** Aromatic gardens, yoga decks, and solar-powered lighting.
- **Tranquil Ambiance:** A peaceful retreat blending nature, relaxation, and wellness.



Poolside Dinning



Lagoon Cabanas



Yoga



Garden Cafes



Flower Garden



Cycling & Running Track

LANDSCAPE DESIGN
PERSPECTIVE VIEW - ARRIVAL



KEY PLAN



LANDSCAPE DESIGN WATER GARDEN



THE WESTIN RESIDENCES
Gurugram, India

SCHEMATIC DESIGN 33
07 MARCH 2025

LANDSCAPE DESIGN

BBQ AND SENSES GARDEN



THE WESTIN RESIDENCES
Gurugram, India

SCHEMATIC DESIGN 45
07 MARCH 2025

LANDSCAPE DESIGN
PERSPECTIVE VIEW - BBQ GARDEN



KEY PLAN



LANDSCAPE DESIGN EVENT LAWN



THE WESTIN RESIDENCES
Gurugram, India

SCHEMATIC DESIGN 49
07 MARCH 2025

LANDSCAPE DESIGN

YOGA AREA & MIYAWAKI GARDEN



THE WESTIN RESIDENCES
Gurugram, India

SCHEMATIC DESIGN 64
07 MARCH 2025

LANDSCAPE DESIGN FIRST FLOOR PLAN

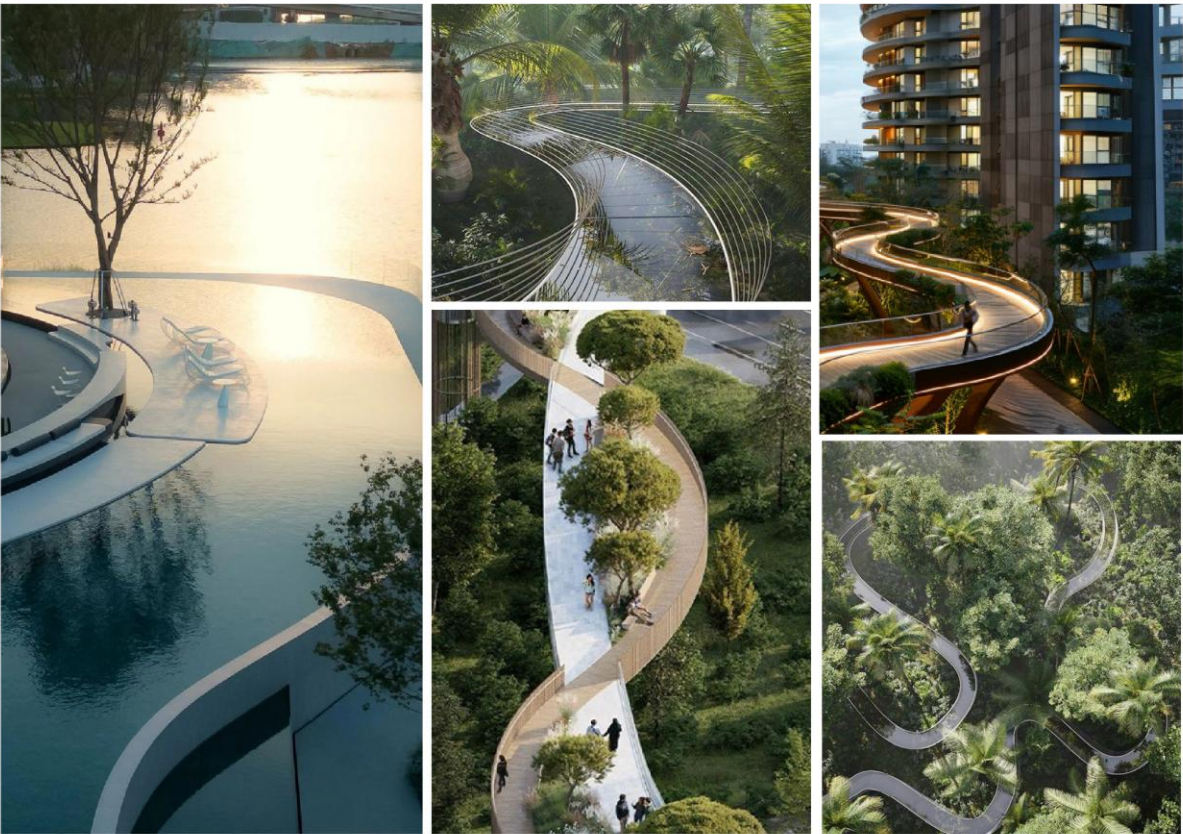

LANDSCAPE DESIGN
BASEMENT PLAN

LEGEND

- 01 All Day Dining with Water Cascade
- 02 Family Pool (Lap Pool: 8x25m)
- 03 Kid's Pool with Slider
- 04 Raised Daybed
- 05 Lagoon
- 06 Party Lawn
- 07 Seating Area
- 08 Lounge
- 09 Pool Showers
- 10 Pool Deck with Lounge



SCHEMATIC DESIGN 84
07 MARCH 2025

LANDSCAPE DESIGN

BASEMENT PLAN - FAMILY POOL



COOPERS HILL

THE WESTIN RESIDENCES
Gurugram, India

SCHEMATIC DESIGN 85
07 MARCH 2025

THE WESTIN
RESIDENCES
GURUGRAM

Whiteland Corporation Private Limited ("Promoter") is the promoter of the residential project named 'Urban Resort' and the project is solely developed, promoted, marketed, and sold by the Promoter. The project 'Urban Resort' is also known as 'Westin Residences, Gurugram' pursuant to a limited license granted by the Marriott Companies to the Promoter for using the 'Westin' trademarks in terms thereof.

LANDSCAPE DESIGN BASEMENT PLAN - PARTY LAWN & ALL DAY DINING

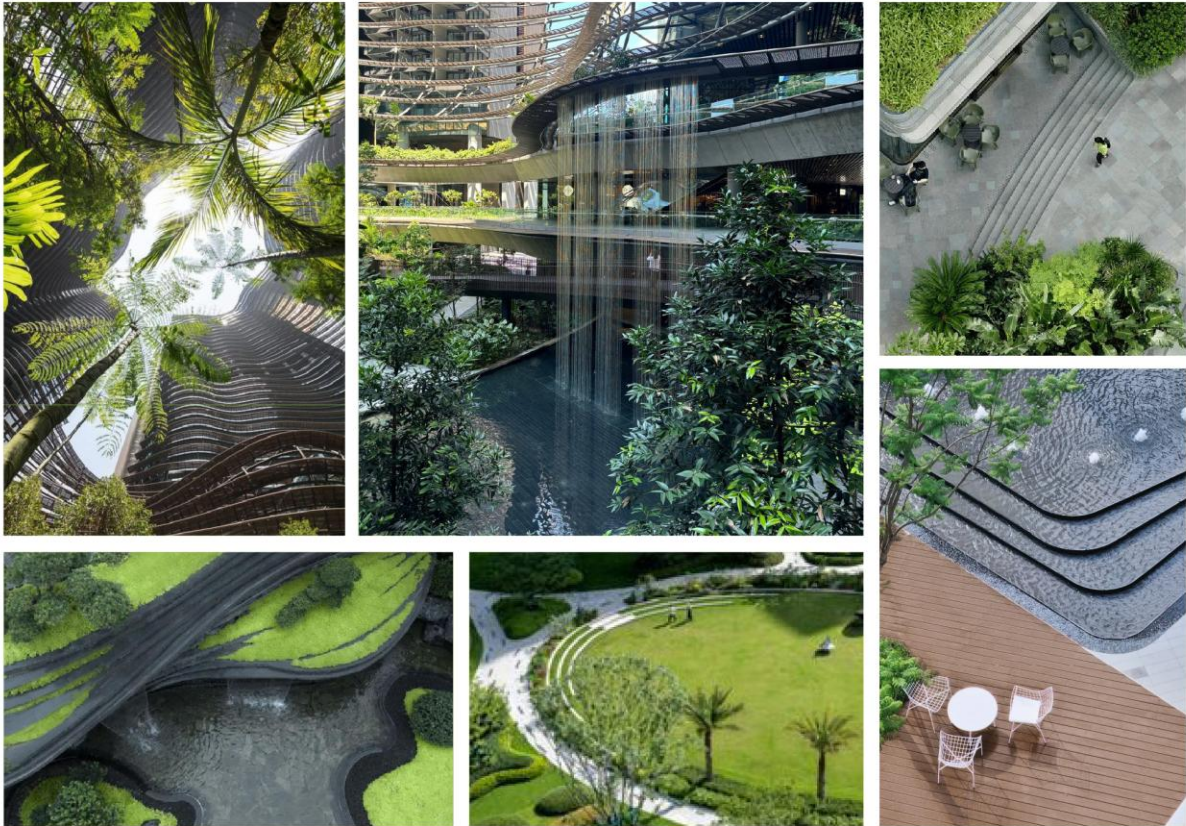

THE WESTIN RESIDENCES
Gurugram, India

SCHEMATIC DESIGN 91
07 MARCH 2025

LANDSCAPE DESIGN
PERSPECTIVE VIEW - CLUBHOUSE COURTYARD



KEY PLAN





Reflective Pool Sit-out



Clubhouse Courtyard



Function Lawn



Lap Pool



Multi Function Sit-out



Senses Garden



Sunken Seat



Void Deck



Water Garden

THE WESTIN
RESIDENCES
GURUGRAM

The Residences



Smart Surveillance & Security



Optimized Delivery Zone



Trash Chute



Smart Storage Solutions



Intelligent Traffic Management
(Basement Levels)



Smart Segregation &
Disposable Management



Master Bedroom



Master Bedroom 2



Living & Dining



Master Washroom

THE WESTIN
RESIDENCES
GURUGRAM

Layouts:
3 BHK

Core Plan: 3 BHK

Large & Small



Typical Floor Plan: Tower 2, 3, 4 & 4A

- Size: 3 BHK Large
- SBA: 2,939 SQ. FT.
- Balcony: 485 SQ. FT.



Typical Floor Plan: Tower 2, 3, 4 & 4A

- Size: 3 BHK Small
- SBA: 2,673 SQ. FT.
- Balcony: 438 SQ. FT.



THE WESTIN
RESIDENCES
GURUGRAM

Layouts:
4 BHK

Core Plan: 4 BHK

Large & Medium



Typical Floor Plan: Tower 5 & 6

- Size: 4 BHK Medium
- SBA: 3,962 SQ. FT.
- Balcony: 374 SQ. FT.



Core Plan: 4 BHK

Small



Typical Floor Plan: Tower 7, 8 & 9

- Size: 4 BHK Small
- SBA: 3,750 SQ. FT.
- Balcony: 338 SQ. FT.



Payment Plan

Payment Plan

Development Linked Plan (35:15:15:25:10)	
On Booking	9% of Total Sale Value
Within 45 Days of Booking	11% of Total Sale Value
Within 75 Days of Booking	10% of Total Sale Value
Within 120 Days of Booking or on Start of Excavation Whichever is Later	5% of Total Sale Value
On Completion of 20 th Floor Slab	15% of Total Sale Value
On Completion of Super Structure	15% of Total Sale Value
On Application of OC (Occupation Certificate)	25% of Total Sale Value
On Offer of Possession	10% of Total Sale Value + 100% OF IFMS + OTHER CHARGES (IF ANY)
<p>Notes:</p> <p>1. Timely Payment Rebate (TPR)*: 3 BHK & 4 BHK (₹ 750/ sq. ft. on Super area) *Timely Payment Rebate as detailed below shall be applicable only when Allotee pays all due instalment on time; otherwise all TPR benefits shall be revoked. 1/ 3rd of the total TPR benefit shall be credited towards the demand 'Within 120 Days of Booking or on Start of Excavation, whichever is Later' subject to timely payment, 1/ 3rd of the total TPR benefit shall be credited towards the demand 'On Completion of Super Structure' subject to timely payment, balance 1/ 3rd of the total TPR benefit shall be credited towards the demand 'On Application of Occupation Certificate' subject to timely payment.</p>	

THE WESTIN

RESIDENCES

GURUGRAM

Thank You

Whiteland Corporation Private Limited ("Promoter") is the promoter of the residential project named 'Urban Resort' and the project is solely developed, promoted, marketed, and sold by the Promoter. The project is not owned, developed, promoted or sold by Marriott International, Inc. or its affiliates ("Marriott Companies"). The project 'Urban Resort' is also known as 'Westin Residences, Gurugram' pursuant to a limited license granted by the Marriott Companies to the Promoter for using the 'Westin' trademarks in terms thereof. If this license is terminated or expires without renewal, the project will no longer be associated with or have any right to use, the Westin brand, trade names or trademarks. Marriott Companies have not confirmed the accuracy of any of the statements or representations made herein or elsewhere in respect of the project. Marriott Companies are not responsible or liable for any representations or defects or any claim whatsoever, relating to the marketing, sale, design or construction of the project.

All information, images, visuals, or sketches, including landscaping shown in this advertisement, are solely an architect's impression, representative images, or artistic renderings and are not to scale. Nothing contained herein is intended to constitute a legal offer and does not form part of any legally binding agreement and/or commitment of any nature. The Promoter endeavours to keep the information up to date and correct. Recipients/viewers are advised to exercise their discretion in relying on the information shown/provided and are requested to verify all details, including area, amenities, services, terms of sales, payments, price, and other relevant terms independently with the sales team/company, have a thorough understanding of the same, and take appropriate advice prior to concluding any decision for buying any unit(s) in the project. Distances as marked are aerial distances and may vary, *1 Hect. = 2.471Acres, 1 Acre = 4840 sq. yds. or 4046.86 sq. mtrs., 1 sq. mtr. = 10.764 sq.ft.